



Kansas Coliseum, Valley Center, KS



Routes to the Show:

From The North or South - I-135 to 85th St N (Exit 17).

One block east to Kansas Coliseum

From The East or West - US 54 (Kellogg St) to I-135; north on I-135 to 85th St N

(Exit17). One block east to Kansas Coliseum

Prelims for breeds will start 30 min after Best of Breed has been judged in the ring or before if all hounds entered are present.

*** NWAKC will host a 50/50 Raffle to help upgrade equipment ***

PREMIUM LIST



Northwest Arkansas Kennel Club

AKC Event # 2012061603 –Friday #1, #2012061604 – Friday #2
#2012061605 – Saturday #2012061606 – Sunday

AMERICAN KENNEL CLUB ALL BREED LURE COURSING TESTS & TRIALS

Friday April 6, 2012 – 2 JC Tests, 2 QC Tests, 2 Coursing Ability Tests

Saturday April 7, 2012 – 1 JC Test 1 QC Test 1 CAT& Trial

Sunday April 8, 2012 – Trial only

Held in conjunction with 3 days of all breed AKC conformation shows, same location:

Salina Kennel Club, Wichita Kennel Club and Hutchison Kennel Club

Kansas Coliseum, Weidemann Park

1229 East 85th St North, Valley Center Kansas

Coursing Field is on the southwest corner of the complex, at the south end of the campground.

Superintendent Onofrio Dog Shows, www.onofrio.com

Pre-Entry is \$18.00 for first entry, \$15.00 for additional hounds per event

PRE-ENTRIES CLOSE Wednesday April 4, 2012

Day of Trial Entry Fees: \$22.00

Entry Closings:

Friday: JC&QC Test & CAT # 1 Starts - 10:00 A.M. – Entries close at 11:00 A.M.

Friday: JC&QC Test & CAT # 2 Starts – 11:15 A.M. – Entries close at 2:30 P.M.

Saturday: JC&QC Test & CAT closes at 10:00 a.m. & Trial closes at 10:30

Sunday: Trial closes at 10:00 a.m.

Field Trial Secretary

Lynette Cole

324 East Glenwood Ave. Rogers AR 72756

479-246-8100

Permission has been granted by the American Kennel Club for the holding of this event under American Kennel Club Rules and Regulations.

Judges:

Jack Downing: 4 Hillcrest Dr. Allen, TX 75002 #26933
 Scott Hurlbert: 4308 Troupe Ave. Kansas City, KS 66102 #49352
 Terry Sayre: 207 S. Melody, Lowell, AR 72745 #74537

Judging Assignments:

Friday JC & QC Test & CAT 1: Scott

Friday JC & QC Test & CAT 2: Terry

Saturday JC & QC Test & CAT: Jack

BIF- Saturday: Jack & Terry Sunday: Scott & Terry

Saturday	A	Az	Ba	B	G	Ib	IG	IW	P	PP	RR	S	SD	SL	TR	W
Jack	X	X	X	X	X	X	X	X	X	X	X	X	X	X	X	X
Scott		X	X		X		X					X	X	X		
Terry	X			X		X		X	X	X	X				X	

Sunday	A	Az	Ba	B	G	Ib	IG	IW	P	PP	RR	S	SD	SL	TR	W
Jack		X	X		X		X					X	X	X		X
Scott	X	X	X	X	X	X	X	X	X	X	X	X	X	X	X	X
Terry	X			X		X		X	X	X	X				X	

Field Trial Committee:

Field Chairman	June Sayre, 207 S Melody Lowell AR 72745 (479) 770-6564
Field Secretary	Lynette Cole , 324 East Glenwood Ave. Rogers AR 72756
Lure Operators	Terry Sayre, Scott Hurlbert, Jack Downing
Huntmaster	Linda Rogers, Linda Petersen,
Inspection	Linda Petersen, Lynette Cole, Jim Purdy, Rae Duane, June Sayre
Field Clerk	Jim Purdy, Linda Rogers, June Sayre
Paddock	Linda Petersen, Linda Rogers, June Sayre

Due to unforeseen circumstances, Committee Members may be substituted as necessary.

Pre-entry Information: All entry forms with payment must be received by the closing date of **Wednesday April 4, 2012** to receive the lower fee. No refunds of entry fees will be given except for bitches in season or hounds lame at the time of roll call. All pre-entries are non-refundable. Changes will be accepted after the deadline only to substitute same breed dogs for lameness or in-season bitches.

Mail entries to: Lynette Cole 324 East Glenwood Ave. Rogers AR 72756

Please fill out an entry for each hound for each day entered.

MAKE CHECKS/MONEY ORDERS PAYABLE TO NWAAC

NWAAC Officers

President – Terry Sayre Vice-President – Emily Williams
 Secretary – Anette Wilson Treasurer – Jackie Gaithe

Directors:

Rae Duane, Jim Purdy, June Sayre

ELIGIBLE BREEDS & REGISTRY:

Afghan Hounds, Basenjis, Borzoi, Cirneco del Etna, Greyhounds, Ibizan Hounds, Italian Greyhounds, Irish Wolfhounds, Pharaoh Hounds, Rhodesian Ridgebacks, Salukis, Scottish Deerhounds, and Whippets. All entries shall be individually registered with the AKC or have been granted an ILP/PAL by the AKC.

Effective January 1, 2008: Azawakh, Portuguese Podengo, Thai Ridgeback and Sloughis, 1 year of age or older, that have been recorded with the Foundation Stock Service (FSS), or that have been granted and Indefinite Listing Privilege (ILP) are eligible to enter lure coursing tests and trial for junior, senior and master courser titles but are not eligible for championship points, and are not eligible to run in Best in Field.

STAKES OFFERED

Junior Courser Test - Hounds must be one year of age or older.

Qualified Courser Certificate – Hounds must be one year of age or older.

Open Stake - Open to eligible hounds who have one or more of the following titles: a) Qualified Courser certificate, Senior Courser, or an *ASFA Field Champion*. (*ASFA Field Champion certificate must be presented with first time entry*)

Veteran Stake - Any eligible sighthound that has met certification requirements whose age exceeds six years, except Irish Wolfhounds whose age shall exceed five years.

Specials Stake - Open to all eligible hounds that have earned their AKC FC title. No championship points are awarded from this stake. *Note: Hounds who have received a disqualification at an AKC trial are ineligible to compete until recertified.*

Qualified Courser (QC) - (Effective 1/1/10). A hound at least 12 months of age (Qualifying Hound) running with another hound of the same breed—or another breed with a similar running style—(Testing Hound) shall receive certification from a licensed judge. The hound must complete the course with enthusiasm and without interruption, sufficiently course the lure and not course the Testing Hound. The judge will certify that the Qualifying Hound ran cleanly and did not appear to present a hazard to the Testing Hound at any point in the qualifying course. This certificate is required to enter a hound in an Open Stake.

Coursing Ability Test (CAT) Coursing Ability Tests are open to all dogs at least 12 months of age that are individually registered with the AKC, recorded in the Foundation Stock Service (FSS) program, individually registered with a foreign or domestic registry organization whose pedigrees are acceptable for AKC registration, dogs granted a Purebred Alternative Listing (PAL) number, dogs with AKC Limited or Conditional Registration, or dogs enrolled in the AKC Canine Partners program. Dogs with breed disqualifications are eligible to enter. Females in season may not enter. A dog may enter only once per event.

RULES & INFORMATION:

All hounds will be checked for breed disqualifications. Altered or neutered hounds may compete. Monorchid and cryptorchid hounds are **NOT** eligible to compete. Bitches in season and lame hounds will be excused. Hounds not present at the time of roll call will be scratched. Muzzles are not required; it is the owner's responsibility to determine if their hound should be muzzled.

BEST IN FIELD WILL BE OFFERED (IG's are not eligible to compete in BIF)

OFFICIAL AMERICAN KENNEL CLUB LURE COURSING ENTRY FORM

Club: NWAKC		Date:	
Location: 1229 East 85th St North, Valley Center Kansas		Event type <input type="checkbox"/> JC1 <input type="checkbox"/> JC2 <input type="checkbox"/> JC Sat <input type="checkbox"/> Trial Sat <input type="checkbox"/> QC1 <input type="checkbox"/> QC2 <input type="checkbox"/> QC Sat <input type="checkbox"/> Trial Sun	
Class: <input type="checkbox"/> Test <input type="checkbox"/> Open <input type="checkbox"/> Special <input type="checkbox"/> Veteran		Breed:	I Enclose Entry fees in the amount of : \$
Breeder:		Sex:	Date of Birth:
<input type="checkbox"/> AKC No. <input type="checkbox"/> AKC Litter No. <input type="checkbox"/> ILP No. <input type="checkbox"/> Foreign No. & list country			
Registration No:			
Full Name of Dog:		Call Name:	
Sire:			
Dam:			
Actual Owner(s):			
Owner's Address:			
City:	State:	Zip:	
Name of Owner's Agent/Handler (if any at Trial):			
AKC Rules, Regulations, Policies and Guidelines are available on the American Kennel Club website: www.akc.org AGREEMENT I CERTIFY that I am the actual owner of this dog, or that I am the duly authorized agent of the actual owner whose name I have entered above. In consideration of the acceptance of this entry. I (we) agree to abide by the rules and regulations of The American Kennel Club in effect at the time of this trial, and by any additional rules and regulations appearing in the premium list for this trial, and entry form. I (we) certify and represent that the dog entered is not a hazard to persons or other dogs. The entry is submitted for acceptance on the foregoing representation and Agreement. I (we) agree that the club holding this event has the right to refuse this entry for cause which the club shall deem sufficient. In consideration of the acceptance of this entry and of the holding of this event and of the opportunity to have the dog judged and to win prize money, ribbons, or trophies, I (we) agree to hold the AKC, the event giving club, their members, directors, governors, officers, agents superintendents or event secretary and the owner or lessor of the premises and any provider of services that are necessary to hold this event and any employees or volunteers of the aforementioned parties, and any AKC approved judge, judging at this event, harmless from any claim for loss or injury which may be alleged to have been caused directly or indirectly to any person or thing by the act of this dog while in or about the event premises or grounds or near any entrance thereto, and I (we) personally assume all responsibility and liability for any such claim; and I (we) further agree to hold the aforementioned parties harmless from any claim for loss, injury or damage to this dog. Additionally, I (we) hereby assume the sole responsibility for and agree to indemnify, defend and save the aforementioned parties harmless from any and all loss and expense (including legal fees) by reason of the liability imposed by law upon any of the aforementioned parties for damage because of bodily injuries, including death at any time resulting there from, sustained by any person or persons, including myself (ourselves) or on account of damage to property, arising out of or in consequence of my (our) participation in this event, however such, injuries death or property damage may be caused, and whether or not the same may have been caused or may be alleged to have been caused by the negligence of the aforementioned parties or any of their employees, agents, or any other persons. I (WE) AGREE THAT ANY CAUSE OF ACTION, CONTROVERSY OR CLAIM ARISING OUT OF OR RELATED TO THE ENTRY, E'HIBITION OR ATTENDANCE AT THE EVENT BETWEEN THE AKC AND MYSELF (OURSELVES) OR AS TO THE CONSTRUCTION, INTERPRETATION AND EFFECT OF THIS AGREEMENT SHALL BE SETTLED BY ARBITRATION PURSUANT TO THE APPLICABLE RULES OF THE AMERICAN ARBITRATION ASSOCIATION. HOWEVER, PRIOR TO ARBITRATION ALL APPLICABLE AKC BYLAWS, RULES, REGULATIONS AND PROCEDURES MUST FIRST BE FOLLOWED AS SET FORTH IN THE AKC CHARTER AND BYLAWS, RULES, REGULATIONS, PUBLISHED POLICIES AND GUIDELINES			
Signature of Owner or Agent duly authorized to make the entry:			
Telephone:		E-mail Address:	
<input type="checkbox"/> Please separate my hounds			
<input type="checkbox"/> Check if hound has been dismissed in last six trials entered.			

OFFICIAL AMERICAN KENNEL CLUB LURE COURSING ENTRY FORM

Club: NWAKC		Date:	
Location: 1229 East 85th St North, Valley Center Kansas		Event type <input type="checkbox"/> JC1 <input type="checkbox"/> JC2 <input type="checkbox"/> JC Sat <input type="checkbox"/> Trial Sat <input type="checkbox"/> QC1 <input type="checkbox"/> QC2 <input type="checkbox"/> QC Sat <input type="checkbox"/> Trial Sun	
Class: <input type="checkbox"/> Test <input type="checkbox"/> Open <input type="checkbox"/> Special <input type="checkbox"/> Veteran		Breed:	I Enclose Entry fees in the amount of : \$
Breeder:		Sex:	Date of Birth:
<input type="checkbox"/> AKC No. <input type="checkbox"/> AKC Litter No. <input type="checkbox"/> ILP No. <input type="checkbox"/> Foreign No. & list country			
Registration No:			
Full Name of Dog:		Call Name:	
Sire:			
Dam:			
Actual Owner(s):			
Owner's Address:			
City:	State:	Zip:	
Name of Owner's Agent/Handler (if any at Trial):			
AKC Rules, Regulations, Policies and Guidelines are available on the American Kennel Club website: www.akc.org AGREEMENT I CERTIFY that I am the actual owner of this dog, or that I am the duly authorized agent of the actual owner whose name I have entered above. In consideration of the acceptance of this entry. I (we) agree to abide by the rules and regulations of The American Kennel Club in effect at the time of this trial, and by any additional rules and regulations appearing in the premium list for this trial, and entry form. I (we) certify and represent that the dog entered is not a hazard to persons or other dogs. The entry is submitted for acceptance on the foregoing representation and Agreement. I (we) agree that the club holding this event has the right to refuse this entry for cause which the club shall deem sufficient. In consideration of the acceptance of this entry and of the holding of this event and of the opportunity to have the dog judged and to win prize money, ribbons, or trophies, I (we) agree to hold the AKC, the event giving club, their members, directors, governors, officers, agents superintendents or event secretary and the owner or lessor of the premises and any provider of services that are necessary to hold this event and any employees or volunteers of the aforementioned parties, and any AKC approved judge, judging at this event, harmless from any claim for loss or injury which may be alleged to have been caused directly or indirectly to any person or thing by the act of this dog while in or about the event premises or grounds or near any entrance thereto, and I (we) personally assume all responsibility and liability for any such claim; and I (we) further agree to hold the aforementioned parties harmless from any claim for loss, injury or damage to this dog. Additionally, I (we) hereby assume the sole responsibility for and agree to indemnify, defend and save the aforementioned parties harmless from any and all loss and expense (including legal fees) by reason of the liability imposed by law upon any of the aforementioned parties for damage because of bodily injuries, including death at any time resulting there from, sustained by any person or persons, including myself (ourselves) or on account of damage to property, arising out of or in consequence of my (our) participation in this event, however such, injuries death or property damage may be caused, and whether or not the same may have been caused or may be alleged to have been caused by the negligence of the aforementioned parties or any of their employees, agents, or any other persons. I (WE) AGREE THAT ANY CAUSE OF ACTION, CONTROVERSY OR CLAIM ARISING OUT OF OR RELATED TO THE ENTRY, E'HIBITION OR ATTENDANCE AT THE EVENT BETWEEN THE AKC AND MYSELF (OURSELVES) OR AS TO THE CONSTRUCTION, INTERPRETATION AND EFFECT OF THIS AGREEMENT SHALL BE SETTLED BY ARBITRATION PURSUANT TO THE APPLICABLE RULES OF THE AMERICAN ARBITRATION ASSOCIATION. HOWEVER, PRIOR TO ARBITRATION ALL APPLICABLE AKC BYLAWS, RULES, REGULATIONS AND PROCEDURES MUST FIRST BE FOLLOWED AS SET FORTH IN THE AKC CHARTER AND BYLAWS, RULES, REGULATIONS, PUBLISHED POLICIES AND GUIDELINES			
Signature of Owner or Agent duly authorized to make the entry:			
Telephone:		E-mail Address:	
<input type="checkbox"/> Please separate my hounds			
<input type="checkbox"/> Check if hound has been dismissed in last six trials entered.			

OFFICIAL AMERICAN KENNEL CLUB LURE COURSING ENTRY FORM

Club: NWAKC		Date:	
Location: 1229 East 85th St North, Valley Center Kansas		Event type Coursing Ability Test (CAT) <input type="checkbox"/> #1CAT Fri <input type="checkbox"/> #2CAT Fri <input type="checkbox"/> CAT Sat	
Class: <input type="checkbox"/> Test <input type="checkbox"/> Open <input type="checkbox"/> Special <input type="checkbox"/> Veteran		Breed: I Enclose Entry fees in the amount of : \$	
Breeder:		Sex:	Date of Birth:
<input type="checkbox"/> AKC No. <input type="checkbox"/> AKC Litter No. <input type="checkbox"/> ILP No. <input type="checkbox"/> Foreign No. & list country Registration No:			
Full Name of Dog:		Call Name:	
Sire:			
Dam:			
Actual Owner(s):			
Owner's Address:			
City:	State:	Zip:	
Name of Owner's Agent/Handler (if any at Trial):			
AKC Rules, Regulations, Policies and Guidelines are available on the American Kennel Club website: www.akk.org AGREEMENT I CERTIFY that I am the actual owner of this dog, or that I am the duly authorized agent of the actual owner whose name I have entered above. In consideration of the acceptance of this entry. I (we) agree to abide by the rules and regulations of The American Kennel Club in effect at the time of this trial, and by any additional rules and regulations appearing in the premium list for this trial, and entry form. I (we) certify and represent that the dog entered is not a hazard to persons or other dogs. The entry is submitted for acceptance on the foregoing representation and Agreement. I (we) agree that the club holding this event has the right to refuse this entry for cause which the club shall deem sufficient. In consideration of the acceptance of this entry and of the holding of this event and of the opportunity to have the dog judged and to win prize money, ribbons, or trophies, I (we) agree to hold the AKC, the event giving club, their members, directors, governors, officers, agents superintendents or event secretary and the owner or lessor of the premises and any provider of services that are necessary to hold this event and any employees or volunteers of the aforementioned parties, and any AKC approved judge, judging at this event, harmless from any claim for loss or injury which may be alleged to have been caused directly or indirectly to any person or thing by the act of this dog while in or about the event premises or grounds or near any entrance thereto, and I (we) personally assume all responsibility and liability for any such claim; and I (we) further agree to hold the aforementioned parties harmless from any claim for loss, injury or damage to this dog. Additionally, I (we) hereby assume the sole responsibility for and agree to indemnify, defend and save the aforementioned parties harmless from any and all loss and expense (including legal fees) by reason of the liability imposed by law upon any of the aforementioned parties for damage because of bodily injuries, including death at any time resulting there from, sustained by any person or persons, including myself (ourselves) or on account of damage to property, arising out of or in consequence of my (our) participation in this event, however such, injuries death or property damage may be caused, and whether or not the same may have been caused or may be alleged to have been caused by the negligence of the aforementioned parties or any of their employees, agents, or any other persons. I (WE) AGREE THAT ANY CAUSE OF ACTION, CONTROVERSY OR CLAIM ARISING OUT OF OR RELATED TO THE ENTRY, E*HIBITION OR ATTENDANCE AT THE EVENT BETWEEN THE AKC AND MYSELF (OURSELVES) OR AS TO THE CONSTRUCTION, INTERPRETATION AND EFFECT OF THIS AGREEMENT SHALL BE SETTLED BY ARBITRATION PURSUANT TO THE APPLICABLE RULES OF THE AMERICAN ARBITRATION ASSOCIATION. HOWEVER, PRIOR TO ARBITRATION ALL APPLICABLE AKC BYLAWS, RULES, REGULATIONS AND PROCEDURES MUST FIRST BE FOLLOWED AS SET FORTH IN THE AKC CHARTER AND BYLAWS, RULES, REGULATIONS, PUBLISHED POLICIES AND GUIDELINES			
Signature of Owner or Agent duly authorized to make the entry:			
Telephone:		E-mail Address:	
<input type="checkbox"/> Please separate my hounds			
<input type="checkbox"/> Check if hound has been dismissed in last six trials entered.			

OFFICIAL AMERICAN KENNEL CLUB LURE COURSING ENTRY FORM

Club: NWAKC		Date:	
Location: 1229 East 85th St North, Valley Center Kansas		Event type Coursing Ability Test (CAT) <input type="checkbox"/> #1CAT Fri <input type="checkbox"/> #2CAT Fri <input type="checkbox"/> CAT Sat	
Class: <input type="checkbox"/> Test <input type="checkbox"/> Open <input type="checkbox"/> Special <input type="checkbox"/> Veteran		Breed: I Enclose Entry fees in the amount of : \$	
Breeder:		Sex:	Date of Birth:
<input type="checkbox"/> AKC No. <input type="checkbox"/> AKC Litter No. <input type="checkbox"/> ILP No. <input type="checkbox"/> Foreign No. & list country Registration No:			
Full Name of Dog:		Call Name:	
Sire:			
Dam:			
Actual Owner(s):			
Owner's Address:			
City:	State:	Zip:	
Name of Owner's Agent/Handler (if any at Trial):			
AKC Rules, Regulations, Policies and Guidelines are available on the American Kennel Club website: www.akk.org AGREEMENT I CERTIFY that I am the actual owner of this dog, or that I am the duly authorized agent of the actual owner whose name I have entered above. In consideration of the acceptance of this entry. I (we) agree to abide by the rules and regulations of The American Kennel Club in effect at the time of this trial, and by any additional rules and regulations appearing in the premium list for this trial, and entry form. I (we) certify and represent that the dog entered is not a hazard to persons or other dogs. The entry is submitted for acceptance on the foregoing representation and Agreement. I (we) agree that the club holding this event has the right to refuse this entry for cause which the club shall deem sufficient. In consideration of the acceptance of this entry and of the holding of this event and of the opportunity to have the dog judged and to win prize money, ribbons, or trophies, I (we) agree to hold the AKC, the event giving club, their members, directors, governors, officers, agents superintendents or event secretary and the owner or lessor of the premises and any provider of services that are necessary to hold this event and any employees or volunteers of the aforementioned parties, and any AKC approved judge, judging at this event, harmless from any claim for loss or injury which may be alleged to have been caused directly or indirectly to any person or thing by the act of this dog while in or about the event premises or grounds or near any entrance thereto, and I (we) personally assume all responsibility and liability for any such claim; and I (we) further agree to hold the aforementioned parties harmless from any claim for loss, injury or damage to this dog. Additionally, I (we) hereby assume the sole responsibility for and agree to indemnify, defend and save the aforementioned parties harmless from any and all loss and expense (including legal fees) by reason of the liability imposed by law upon any of the aforementioned parties for damage because of bodily injuries, including death at any time resulting there from, sustained by any person or persons, including myself (ourselves) or on account of damage to property, arising out of or in consequence of my (our) participation in this event, however such, injuries death or property damage may be caused, and whether or not the same may have been caused or may be alleged to have been caused by the negligence of the aforementioned parties or any of their employees, agents, or any other persons. I (WE) AGREE THAT ANY CAUSE OF ACTION, CONTROVERSY OR CLAIM ARISING OUT OF OR RELATED TO THE ENTRY, E*HIBITION OR ATTENDANCE AT THE EVENT BETWEEN THE AKC AND MYSELF (OURSELVES) OR AS TO THE CONSTRUCTION, INTERPRETATION AND EFFECT OF THIS AGREEMENT SHALL BE SETTLED BY ARBITRATION PURSUANT TO THE APPLICABLE RULES OF THE AMERICAN ARBITRATION ASSOCIATION. HOWEVER, PRIOR TO ARBITRATION ALL APPLICABLE AKC BYLAWS, RULES, REGULATIONS AND PROCEDURES MUST FIRST BE FOLLOWED AS SET FORTH IN THE AKC CHARTER AND BYLAWS, RULES, REGULATIONS, PUBLISHED POLICIES AND GUIDELINES			
Signature of Owner or Agent duly authorized to make the entry:			
Telephone:		E-mail Address:	
<input type="checkbox"/> Please separate my hounds			
<input type="checkbox"/> Check if hound has been dismissed in last six trials entered.			



AMERICAN
KENNEL CLUB®

Qualified Coursing Certificate

Instructions: This form is to be used when a hound successfully completes the Qualified Coursing Test at an AKC Lure Coursing event. A hound must have received this certification within one year of the closing date of the trial being entered to be eligible to compete in an AKC Lure Coursing Trial in the Open or Open Veteran stake. This form must be properly completed and submitted along with this hound's first entry in an AKC Lure Coursing Trial in either stake.

* Hounds who have earned a Field Championship from either the American Sighthound Field Association (ASFA) or the Canadian Kennel Club (CKC) are exempt from this requirement.

To be completed by owner/agent:

Breed _____

AKC Registered Name _____

AKC Registration Number _____

I hereby certify that the hound running in the Qualifying Course is the hound identified above and the information provided is true and correct.

Printed Name of Owner/Agent: _____

Signature of Owner/Agent _____ Date _____

To be completed by certifying judge:

I hereby certify that the above referenced hound passed the Qualified Coursing Test by running clean with another hound of the same breed or one with a similar running style completing a course a minimum of 600 yards.

Judge's Printed Name _____ Judge's Number _____

Judge's Signature: _____ Date _____



AMERICAN
KENNEL CLUB®

Qualified Coursing Certificate

Instructions: This form is to be used when a hound successfully completes the Qualified Coursing Test at an AKC Lure Coursing event. A hound must have received this certification within one year of the closing date of the trial being entered to be eligible to compete in an AKC Lure Coursing Trial in the Open or Open Veteran stake. This form must be properly completed and submitted along with this hound's first entry in an AKC Lure Coursing Trial in either stake.

* Hounds who have earned a Field Championship from either the American Sighthound Field Association (ASFA) or the Canadian Kennel Club (CKC) are exempt from this requirement.

To be completed by owner/agent:

Breed _____

AKC Registered Name _____

AKC Registration Number _____

I hereby certify that the hound running in the Qualifying Course is the hound identified above and the information provided is true and correct.

Printed Name of Owner/Agent: _____

Signature of Owner/Agent _____ Date _____

To be completed by certifying judge:

I hereby certify that the above referenced hound passed the Qualified Coursing Test by running clean with another hound of the same breed or one with a similar running style completing a course a minimum of 600 yards.

Judge's Printed Name: _____ Judge's Number: _____

Judge's Signature: _____ Date _____

**PLEASE FILL OUT AN ENTRY FORM FOR EACH DAY
FOR EACH HOUND, AND EACH EVENT ENTERED.**

If entries are not legible, and filled out properly, they will not be accepted.

ADDITIONAL INFORMATION:

- ✓ All entries must be one year of age or over on the day of test
- ✓ Lure machine is battery powered, continuous loop. Back-up equipment is available.
- ✓ The lure will consist of highly visible plastic strips.
- ✓ A fee of \$35.00 will be assessed for any returned checks.
- ✓ There will be a \$5.00 fine for any loose hound on the field that is not a part of the course in progress.

AWARDS FOR JC TEST AND TRIAL

A Dark Green Ribbon, for hounds successfully completing Junior and Qualified Courser test.
 First place - Blue ribbon; Second place- Red ribbon; Third place - Yellow ribbon; Fourth place - White ribbon; Fifth place - Pink ribbon;
 BOB - Purple/Gold rosette. BIF – Red, White & Blue rosette.

DIRECTIONS

The field is east of the show building, across the parking lot.

Motels and Camping

HOTEL INFORMATION IN Wichita THAT MAY ACCEPT DOGS

Please check the hotel policy on pets.

Econo Lodge	600 Holland Dr, W Hwy 54	1-800-926-0721
Clarion Inn & Suites	5805 W Kellogg	1-316-942-7911
Motel 6	5736 W Kellogg	1-316-945-8440
Hawthorne Suites LTD	2405 N Ridge Rd, Wichita	1-316-729-5700

Camping is allowed on the fairground site.

Hookups are available from the fairgrounds.

There are minimal hookups available at the coursing field for \$15.00 a day.

NEAREST VETERINARY CLINICS

Veterinarian will be available at the show building during show hours.

Chisholm Trail Animal Health Care Center	1726 E 61 st St N, Wichita KS 67219	316-744-0501 316-744-0443
Emergency Vet Clinic	737 S Washington	316-262-5321 MUST CALL AHEAD

Restroom & water is available at field.

Concessions are available inside the show building.

FUTURE LURE COURSING TRIALS

Information regarding future lure coursing can be found at www.gazehoundsintexas.org & www.alamoareawhippetclub.com

Course Plans:

NWAKC reserves the right to alter the course plan as required by weather and/or field conditions on the day of the trial. **Equipment will not be set in line with run in direction.**

Friday's Course plan- 805 yards

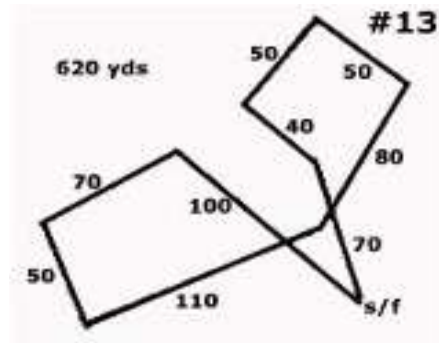

Saturday's Course Plan 810 yards

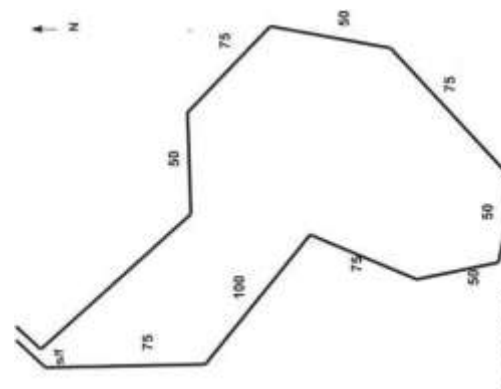
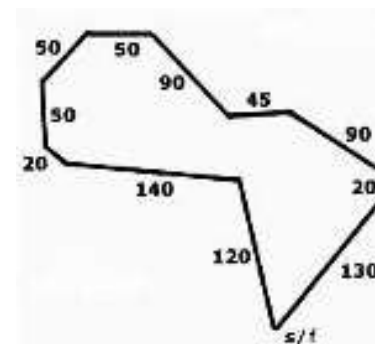

Sunday's Course Plan – 700 yds